

MINI-10

RECESSED CONTACTS

.37"(9.5mm) Mini-Recessed Type



Contact Size: .37"×.61"(9.5mm×15.5mm)

Standard Magnet Size: .37"×.61"(9.5mm×15.5mm)

Standard Gap: .5"(12.5mm)

Colors: White, Brown

12"(305mm) 22 AWG Leads Standard

Longer leads available.

Specifications

Part Number	Gap Inch(mm)	Loop Open/Closed	Reed Form	Max. Contact Rating (W)	Max. Initial Contact Resistance (mΩ)	Max. Switching Voltage (V)	Max. Switching Current (A)
MINI-10	.5"(12.5)	CLOSED	Normally Open	10	100	AC24/DC24	0.1
MINI-10 WG	1"(25)	CLOSED	Normally Open	10	100	AC24/DC24	0.1
MINI-10 W/STB-10	.5"(12.5)	CLOSED	Normally Open	10	100	AC24/DC24	0.1
MINI-10 DM	.5"(12.5)	CLOSED	Normally Open	10	100	AC24/DC24	0.1

OPERATING TEMPERATURE:-40°C to +60°C

Outline Dimensions

Unit: inch(mm)

MINI-10

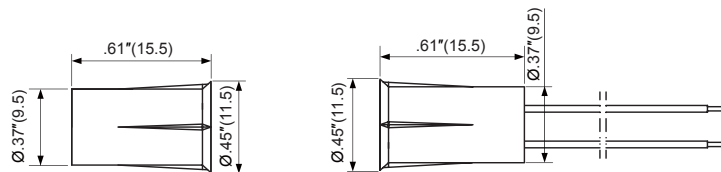

"We Contact The World"®

The Best Guarantee Since 1984 : \$50-1

TANE ALARM PRODUCTS

MINI-10

RECESSED CONTACTS

Outline Dimensions

Unit: inch(mm)

MINI-10 WG



Bare Rare Earth
(BT 3/8"×3/4")

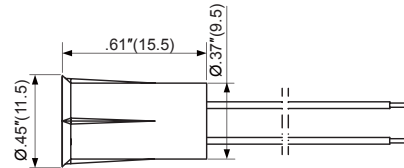
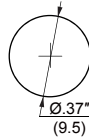
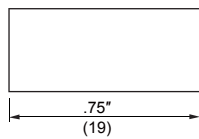

MINI-10 W/STB-10

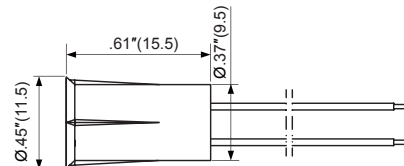
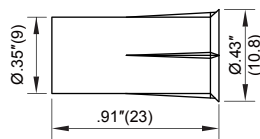

MINI-10 DM



Bare Rare Earth
(BT 3/8"×1/8"DM)

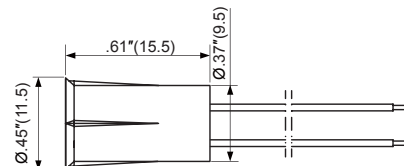
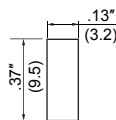
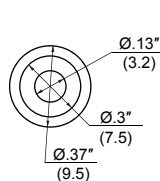

"We Contact The World"®

The Best Guarantee Since 1984 : \$50-1

TANE ALARM PRODUCTS